



## **MINUTES OF THE SOUTH EAST AREA COMMITTEE MEETING**

**HELD ON MONDAY 14 NOVEMBER 2022**

- 1 **Presentation on the Duke Street Anne Street South Public Realm Scheme**  
**Order: Noted.**
- 2 **Presentation on Temple Bar**  
**Order: Noted.**
- 3 **Minutes of the South East Area Committee Meeting held on 10th October 2022**  
**Order: Agreed.**
- 4 **Environment & Transportation Department Matters**
  - i. South East Area Traffic Advisory Group Meeting Minutes 25/10/2022.  
**Order: Noted.**
  - ii. Report on Fishamble Street and Parliament Street Proposals.  
**Order: Agreed.**
- 5 **Culture, Recreation and Economic Services Department Matters**
  - i. Nomination of a Councillor from the South East Area to be a member of the selection panel in the commissioning process for the new sculpture in Dartmouth Square.  
**Order: Deferred to the December meeting of the South East Area Committee. Any Councillors interested in being on this panel should notify the Chairperson before the December meeting.**
- 6 **Housing and Community Department Matters**
  - i. Report on Community Grants Scheme 2022.  
**Order: Agreed to recommend to City Council.**
- 7 **Planning & Development Department Matters**
  - i. Report on proposed disposal of strip of land in front of 20 Pigeon House Road.  
**Order: Agreed to recommend to City Council.**
  - ii. Report on proposed disposal of a plot of land at 1C Dartry Road.  
**Order: Agreed to recommend to City Council.**

## South East Area Matters

- i. Nomination of a member of the South East Area Committee to replace Cllr. Kevin Donoghue on the South East Inner City Local Drugs and Alcohol Task Force.

**Order: Deferred to December South East Area Committee meeting.**

- ii. Nomination of a member of the South East Area Committee to the Eirgrid Community Forum.

**Order: Cllr. Lacey was nominated by Cllr. Freehill and approved by the committee members.**

- iii. Report of the Director of Services, South City.

**Order: Noted.**

## Motions 14th November 2022

### **Motion 1 Councillor Dermot Lacey**

This committee requests the Manager to arrange for a presentation to Councillors on this plan for Major Flood Defence Proposals along the Dodder to Councillors as outlined in the extract from an article submitted with this Motion.

#### MAJOR FLOOD DEFENCE PROPOSALS

Dublin City Council is advancing plans to enhance flood protection on the River Dodder from Waldron's Bridge, Churchtown, to Clonskeagh Bridge.

Contractors .....have presented the Council with proposals for this flood protection which has been in the offing for decades.

Scully's Field, the wild plot of land which stretches from Strand Terrace in Milltown to Farmer Brown's in Clonskeagh has been largely left alone to act as a "flood plain" as an undeveloped site.

A flood defence wall to protect Shanagarry Apartments, just beyond the Packhorse Bridge on the city side of the river, is now set around the apartments rather than between the river and the riverside path.

New flood walls are proposed for several sites: to protect the car park at Farmer Browns beside Clonskeagh Bridge where "glass panels" are to be installed so we can see the river as the wall could be up to 3.1 metre high; between the river and the path at Strand Terrace in Milltown there will be a wall up to 2.2 metres high (at the entrance to the Scully's Field walk), which will end in a large embankment along the side of Milltown car park; new walls up to 1.5 metres high are proposed to enclose Milltown Green opposite Milltown Church, being built between the road and the park and between the river and the park - New or enhanced walls travelling upriver do seem to follow the line of existing walls on the Milltown Road and at the Dropping Well Pub there is a new wall between the pub car park and the river but at least not between the river and the river walk. The flood defence walls to protect the houses on the hill between the Dye Works and Dartry Park seem to run along the river bank and are up to 1.6 metres high.

**Order: Report to Councillor.**

### **Motion 2 Councillor Dermot Lacey**

Given the impact of the Belmont Avenue Traffic Calming scheme this Committee requests the Traffic Department to begin to examine an appropriate scheme for the parallel Marlborough Road.

**Order: Report to Councillor.**

### **Motion 3 Councillor Claire Byrne formerly Mot 19 October 2022 deferred**

That this Area Committee calls on the Area Manager to outline what measures are being undertaken to address the ongoing issue of the misuse of tarmac being

dumped on the footpaths around the South East Inner City as an interim fix which is unsightly and a trip hazard. Can the Area Manager please outline why this is seems to be the preferred practice of Dublin City Council rather than proper fixing of footpaths and when what can be done to put an end to this and to fix the footpaths in the area properly to make it safer and more attractive.

**Order: Report to Councillor.**

**Motion 4 Councillor Mary Freehill**

That an examination as to suitability of Hazel trees located on Kenilworth Road be carried out. The adjoining area of Grosvenor Place and Effra Road which is a low lying area and is the location of the Swan underground river junction has been vulnerable to flooding in the past to the extent that basements on Grosvenor Place have been flooded. These trees produce large nuts that clog up the gullies which is very dangerous in this area. We agree that an examination be carried out by both the Drainage Division and the Parks Dept. and to report back to December meeting with recommendations.

**Order: Report to Councillor.**

**Motion 5 Councillor Mary Freehill**

That DCC arranges a meeting with Irish Water to discuss support systems that need to be established in the event of water supply outage. Recently families were left without water supply for a number of days (in the Bushy Park Road / Rathgar / Terenure area). No initiative was taken to help with water tanks, clearly a protocol needs to be put in place to deal with these events.

**Order: Report to Councillor.**

**Motion 6 Councillors Tara Deacy and Carolyn Moore**

That this committee agrees to discuss and agree upon workable solutions to the ongoing issues we are experiencing with illegal parking in cycle lanes in Harold's Cross, Rathmines Road among other areas, particularly at morning and afternoon rush hours / school runs.

That this committee agrees to write directly to the relevant Chief Supers in the area to assist us with enforcement.

That this committee at a minimum agrees deliveries should happen before 8am and that vehicles stop outside the cycle lane.





**Order: Agreed.**

**Motion 7 Councillor Mary Freehill**

That the Parks Department reports on why these trees have been pruned in such a lopsided way which seriously impacts on safety of pedestrians. Furthermore it is agreed by this committee that the Department let us know when work will be done to properly prune these trees on Bushy Park Road.

**Order: Report to Councillor.**

**Motion 8 Councillor Claire Byrne**

That this Area Committee calls on the Area Manager to put in place a zebra crossing at the junction of Camden Row and Camden Street.

**Order: Report to Councillor.**

**Motion 9 Councillor Claire Byrne**

That this Area Committee calls on the Area Manager to develop a public realm plan for Dame Lane.

**Order: Report to Councillor.**

**Motion 10 Councillor Claire Byrne**

That this Area Committee agrees that Dublin City Council will include funding for the redesign of Portobello Plaza in the Dublin City Council budget 2023.

**Order: Report to Councillor.**

**Motion 11 from Councillor Claire Byrne**

That this Area Committee calls on the Area Manager to examine the very serious situation of large delivery vehicles accessing the new supermarket on South Lotts Road and the safety risk this poses to pedestrians in the area.

**Order: Report to Councillor.**

**Motion 12 from Councillor Pat Dunne**

This Area Committee recognises the importance of the former convent on Armagh Road, Crumlin as an active community facility within the scope of its Z15 zoning. The current usage by the Hope Centre allows and includes wider community usage. There is also a demand by other community groups who would gladly use this facility if it was available.

**Order: Agreed.**

### **Motion 13 Councillor Mary Freehill**

This local area committee calls on the Minister for Social & Family Affairs to use her influence to reverse the Citizens' Information Board's decision to close the very busy Rathmines Citizens' Information Service (CIS). The closure went ahead despite this committee's efforts, along with other local groups, to keep it open. This service has been present in Rathmines for the past 46 years. The consequence of this is the loss of outreach service to St Vincent's Hospital, Elm Park and Hospice in Harold's Cross.

In a report prepared by Department of Social Protection "Periodic Critical Review of the Citizens Information Board May 2022". It states on page 18 that there was a 46% decline in the use of in-person CIC services between 2019 and 2021. This statistic seriously distorts reality as all CIS centre were closed for the vast amount of this period because of COVID"

The general diminution of face to face drop in CIS state service nationally is a serious breach of citizens' rights and the mission of the Citizens' Information Board. It impacts on people who need help to access and explain information along with form filling, people who do not have access to IT especially older people and people who have poor language competency.

This problem is further exacerbated by the diminished drop in service from 5 day to 3 day and by prior appointment only in Crumlin Sundrive Road Centre, the closure of the very busy CIS in Tallaght Shopping Centre and City Centre O'Connell Street premises. The national CIS phone service now has a very long wait time to access their service.

This committee would welcome an opportunity to meet you to explain the impact the loss of this face to face state service is having on vulnerable people and to express our serious concern at the way it is being run down.

**Order: Agreed.**

### **Motion 14 Councillor Carolyn Moore**

This committee agrees to roll out a 'park warden pilot' in the Dublin 12 area, modelled on the pilot scheme currently underway in Dublin 8 which has seen the appointment of a park warden to service three parks in the Dublin 8 area. This committee agrees with the many stakeholders who have contributed to discussions around the need for wardens in Dublin 12 parks and proposes that Eamonn Ceannt Park, Brickfields Park and Pearse Park and their users would be well served by the presence of a warden and are geographically well placed to participate in such a pilot, which would provide an opportunity to measure the success and impact on the operation, management and safety of these parks.

**Order: Report to Councillor.**

### **Motion 15 Councillor Carolyn Moore**

This committee calls on the area manager to ensure that the four bicycle stands removed from the village of Harold's Cross to facilitate construction site hoarding are urgently reinstated in a suitable location. The village is already under-served with bicycle parking and the prolonged loss of four Sheffield stands for an unspecified period of time is unacceptable.

**Order: Agreed.**

### **Motion 16 Councillor Carolyn Moore**

This committee acknowledges the work of parents in voluntarily marshalling and managing the traffic caused by school and crèche drop offs at St. Louis infant school and primary school in Rathmines, and is concerned by recent developments, including traffic incidents and abusive and intimidating behaviour towards parents,

which has required the presence of the Gardaí in the mornings to steward the area and ensure the safe passage of children into the schools.

This committee calls on traffic engineers to engage with the St. Louis Parents' Association to find an appropriate traffic solution to trial at this location which would restrict or otherwise prevent traffic from turning left off the roundabout at the junction of Williams Park and Ardee Road between the hours of 8.15 and 8.45, while maintaining access to this section of Williams Park for residents. This could be some kind of retractable bollard that would filter permeability during school drop off times; signage that would give the volunteer marshals some authority to prevent drop offs in this zone; or an enhanced school zone treatment for the infant school which would make it a car free zone during drop off times.

**Order: Report to Councillor.**

**Motion 17 Councillor Danny Byrne**

That this area committee would agree to write to all community tidy towns groups in the south east area to thank them for their most helpful work throughout the year.

**Order: Report to Councillor.**

**Emergency Motion Councillor Claire Byrne**

That this Area Committee calls on the Area Manager to allow the Chestnut Bazaar on Clanbrassil Street remain in place until the site is ready to be developed. This is an excellent meanwhile use of a space that had been vacant or underutilised for years and is a real asset to the local community while supporting local entrepreneurs. This is something we as a council should be supporting at every opportunity not closing prematurely.

**Order: Report to Councillor.**

10 **Questions for the Chief Executive 14th November 2022.**

Note re error in the questions listed in the agenda: Questions 76 and 77 should have been credited to Councillor Deirdre Conroy.

**Order: Noted.**

**Councillor Dermot Lacey**

**Chairperson**

**Monday 14 November 2022**

**Attendance:**

**Members:**

Dermot Lacey (Chairperson)  
Claire Byrne  
Deirdre Conroy  
Kevin Donoghue  
Mannix Flynn  
Paddy McCartan

**Members:**

Danny Byrne  
Daniel Céitinn  
Pat Dunne  
Mary Freehill  
Carolyn Moore

**Members:**

Hazel Chu  
Tara Deacy  
Anne Feeney  
James Geoghegan  
Claire O'Connor

**Officers**

Mark Ginnetty  
Karl Mitchell  
Paul McCann  
Iva Geci  
Blathnaid Conlon

Brian Hanney  
Fiona O'Brien  
Jill McGovern  
Neil O'Donoghue  
Ruairí Ó Cúiv

John MacEvilly  
Neil O'Donoghue  
Marie Gavin  
Zsolt Zsombatfalvi  
Claire French

**Non-Members:**

Martin Harte, Temple Bar  
Company.

Ainsley Kavanagh, Temple  
Bar Company.

**Q.1 Councillor Dermot Lacey**

To ask the Manager if he will have the appalling state of the roadway at Granite Place, Ballsbridge – under the arch – examined with a view to making it safe and resurfacing as soon as possible.

**Reply:**

Please be advised that Road Maintenance Services has been in communication with Dublin City Council Water Services on November 1<sup>st</sup>, 2022 to carry out permanent reinstatement roadworks on the concrete road at Granite Place, Ballsbridge.

Dublin City Council Water Services has instructed their contractor DJ O'Neill to carry out the permanent reinstatement works.

**Q.2 Councillor Dermot Lacey**

To ask the Manager if he will look positively at the suggestion submitted with this question regarding the entrance to Ranelagh Park.

There is a small planting area on Chelmsford Avenue at the entrance to Ranelagh Park. Pre-Covid this was maintained by the City Council with weeding and planting (flowers) twice a year. It has now become a wilderness, tramped on by kids and generally in an appalling state. See first two images attached

It has been suggested that this area be planted with low, various coloured shrubbery which would require low maintenance. I enclose the second two images, by way of example. The first is one maintained by the residents of Northbrook Av along the base of the Luas line. The second is a DCC area recently planted in Merrion Square. Residents also wish to have the granite stones currently lodged at random removed. In its current state people have tripped over these hidden in the long weeds. Secondly, they inhibit ease of weeding when the area is maintained. This full area stretches along the outer wall of the park, but local residents maintain in exemplary fashion the long strip narrow section. In the area in question, immediately beside the entrance only, local residents are happy to maintain it if planted. We would ask that a strip (c. 30 cms) be left around the edge for a twice yearly rotation of bedding plants by locals.

I attach some photographs.

**Reply:**

Parks Services have listed this proposal for consideration during the development & budgetary stage of the future Parks Improvement programme.

**Q.3 Councillor Dermot Lacey**

To ask the Manager if he will arrange for the lighting in (details supplied) fixed as soon as possible as we are coming in the dark evenings.

- Nutley Park, Donnybrook – particularly in the vicinity of numbers 48-58.

**Reply:**

Lights 2 and 10 Nutley Park were repaired on 4<sup>th</sup> November 2022.

**Q.4 Councillor James Geoghegan**

To ask the Area Manager if Clyde Road in Ballsbridge, Dublin 4 and where possible, Raglan Road, Dublin 4, could have the leaves on the footpaths cleaned where they are busy pedestrian thoroughfares and also adjacent to an elderly population.



**Reply:**

Waste Management Services will ensure the above mentioned roads are included as often as possible during our leaf removal programme over the autumn and winter months.

**Q.5 Councillor James Geoghegan**

To ask the Area Manager if he could address the issues raised in the email below and photo attached in respect of accessibility issues on Brighton Road, Rathgar, Dublin 6.

“Further to my previous email, daylight revealed a second street light at the top of Brighton Road which is totally blocked by a tree growing behind it. (Please see footpath in darkness.) So, the two lights at either side of Brighton Road are blocked by trees. The one on the right by a tree growing in the garden of a building occupied by a crèche and the other by a tall tree growing behind it. The net result is that the area is bathed in darkness at night. The only glimmer of light is in the centre of the road with cars coming around the corner quickly off the main road.

I am elderly with impaired eye sight and am frightened of going to Rathgar shops after dark.

Can you attempt to have the branches cut down please?”



**Reply:**

Parks Services visited the locus to carry out assessment of the tree crown interference with the lamp. It has been confirmed that the subject tree is in close proximity to the lamp stand but isn't covered by it. Slight trimming works to the tree is listed in the Tree Maintenance Programme for the area.

Public Lighting Services will request the Parks Department to prune the street tree beside Pole 12 Brighton Road.

We will contact the crèche regarding their private tree and request they prune the trees that are blocking the light from Pole 11.

**Q.6 Councillor Dermot Lacey**

To request the Manager to examine Sandford Avenue, Donnybrook and include it on the road maintenance programme.

**Reply:**

Sandford Avenue will be inspected and put forward for consideration for inclusion in our future resurfacing programmes accordingly.

**Q.7 Councillor Dermot Lacey**

To ask the Manager if a submission has yet been made by the Developer Marlet Property Group regarding the naming of Theatre Royal Way as promised in the email submitted with this question.

Marlet Property Group is happy to facilitate the request of naming the new pedestrian street across Hawkins Street to "Theatre Royal Way" subject to approval by the DCC. Our updated naming and numbering proposal for the development will be submitted to DCC in the coming weeks and "Theatre Royal Way" will be included in this.

**Reply:**

Dublin City Council has received correspondence from Marlet Property Group who have indicated their intention to include the name Theatre Royal Way in a revised naming strategy for their development at Hawkins Street / Tara Street. However the South East Area Office or Planning Compliance have not yet received a revised naming and numbering proposal as described above.

**Q.8 Councillor Dermot Lacey**

To ask the Manager to arrange for the pooling issue outside St. Mary's NS Mt Eden Road, Donnybrook, Dublin 4 to be dealt with as soon as possible and long before this question is reached for reply and also to attend to the re-installation of the yellow box at the new school entrance on Mt Eden Road, adjacent to 7 Mount Eden Road. There was a yellow box here when the school moved on to the site originally but it has become faded due to the excessive builder's traffic during the construction of the new school.

**Reply:**

The location will be inspected in the coming days. Any requirement for renewal will take place within 30 working days of the SEAC meeting of the 14/10/22

The entrance to St. Mary's School was inspected on the morning after heavy rain and no ponding was present. It was noted that there were a large amount of leaves in the vicinity of the gully at this location which may be periodically blocking the gully. We have requested Waste Management Division to sweep the area and we have also requested Drainage Division to clean out the gully.

**Q.9 Councillor James Geoghegan**

To ask the Area Manager if the issues with parking in Elmwood Avenue and Beechwood Avenue could be addressed.

**Reply:**

The parking enforcement inspector will visit the location and carry out an assessment in relation to what parking enforcement measures may be suitable, he will report his findings to the area engineer for review.

Parking obstructions can be reported to Dublin Street Parking Services for enforcement at **01 602 2500**.

**Q.10 Councillor James Geoghegan**

To ask the Area Manager if he can address the following issue;

"Lighting issues: Ranelagh Road at Smyth's pub there are 3 street light s in a row not working. East Link Bridge access road there are about 8 lights not working from the toll booth to the roundabout at Sean Moore Road. There are also several lights around the toll booths not working."

**Reply:**

Public Lighting Services require more information regarding the lights that are not working.

With regards to Ranelagh Road, poles 30 and 36 have a dead ESB service in them, and they have been passed to the ESB for repair. However, these two lights are not beside Smyth's pub.

A night check was carried out a few weeks ago and any faulty lights identified were repaired.

If the Councillor can provide the pole numbers of the lights they are referring to, we will examine those lights and arrange for any repairs that may be necessary.

With regards to the East Link Bridge Access road and the tollbooths, we will arrange for a special night check to be carried out to determine which lights are not working. Following this, a traffic management plan will need to be devised to allow for the safe examination of the identified lights to determine why the lights are out, before any necessary repairs can be undertaken.

**Q.11 Councillor Dermot Lacey**

To ask the Manager if he will respond positively to the request for road and footpath maintenance as sought in the email supplied with this question.

"May I start by saying thank you to those involved in the recent repair of the footpaths on Burlington Road, it was great to see this work done.

However the pavements on Waterloo Road need repair and I see you have been carrying out some repairs recently so I have highlighted some of the areas. Please see some photos below:

Pavement outside no 1 Waterloo Road (first 4 photos) pavement outside no 29 Waterloo Road (last 2 photos).

There are many other parts of the pavements that need repair and Burlington Road needs to be resurfaced both for the sake of both cars & pedestrians.



**Reply:**

Burlington Road (from Waterloo Road to past Waterloo Lane) is due to be resurfaced as part of our 2022 Carriageway Resurfacing Programme.

The footpath on Waterloo Road has been inspected at the locations referred to and the defects noted have been recorded on our Works Lists for repairs to be carried out when we next have a crew in this area.

**.12 Councillor Dermot Lacey**

To ask the Manager to request a report from the drainage section as to what action can and will be taken to deal with this problem with serious flooding that occurs each time it rains heavily.

"The attached photos give you an idea and it was the same on the other side of the road. This happens every time we have heavy rain which is nearly every time it rains now. Apart from the drains being blocked with leaves there are not enough drains and this has been going on for years.

I am terrified every time as with cars, buses etc. driving through, the water is pushed our laneway and hence this is how we have been flooded.

Something needs to be done as with the rains getting more tropical I am afraid we will be flooded again.

I am hoping you can get the Drainage people to put in additional drains on Morehampton Road. It is a busy road and I had to walk down the centre to avoid the floods and of course got drenched in any case from the passing cars."

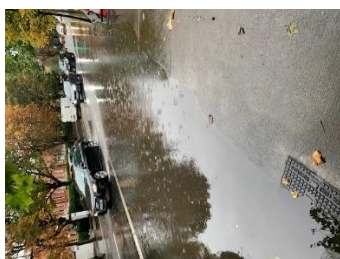
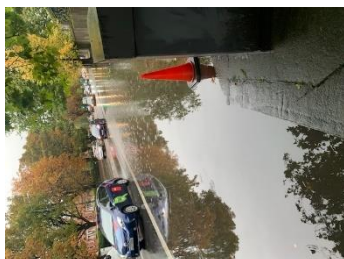

**Reply:**

On foot of flooding investigations DCC Drainage renewed the surface water sewer on the eastern side of Morehampton Road here in 2021 which had become blocked by tree roots and an additional gully was added. There are circa 15 gullies here now between Swan Place and Bloomfield Ave.

The most recent flooding at this location (20<sup>th</sup> October last) was caused by fallen leaves blocking gullies. Once the leaves were removed all the flooding cleared.

Some recent storm events (such as 4<sup>th</sup> September 2022) exceeded the standard design basis of sewers and in such circumstances road flooding would be expected regardless of the number of gullies provided... The main sewer here forms part of the R&P Sewer network and there are known issues with this system (and many historic incidents of flooding at this particular location). Studies on the R&P Sewer Network commenced by DCC were passed over to Irish Water in 2014 to be continued.

This is a sewer capacity issue exacerbated by leaf fall at this time of the year. It is unlikely that additional gullies will solve any problems. However, where warranted, DCC will install. DCC Drainage will continue to prioritise the area during rainfall events as well as liaising with our colleagues in Waste Management in relation to clearing of leaves.

**Q.13 Councillor Dermot Lacey**

Can the Manger report on the likely progress of the pedestrian crossing at Serpentine Avenue / Merrion Road as long sought by residents and Councillors?

**Reply:**

There is currently a signalised pedestrian crossing at this junction across the main road Merrion Road.

BusConnects proposes signalised pedestrian crossing facilities on all approaches to the junction, as below, and these would then operate as a dedicated phase/stage (wrap-around) pedestrian crossing movement.

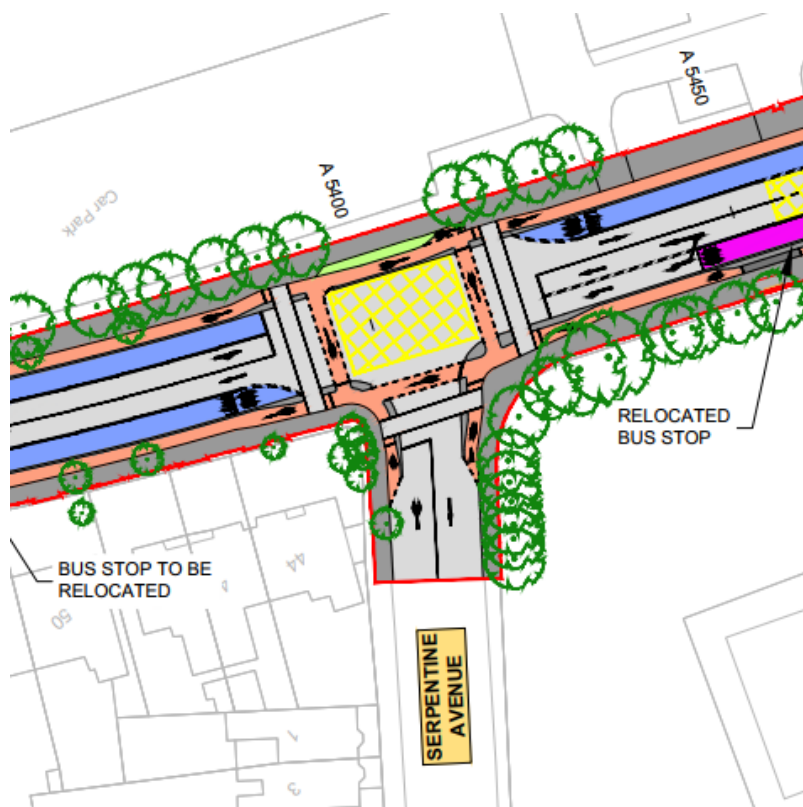

This proposal is part of the BusConnects CBC route14 / 15 Blackrock / UCD to City Centre. This scheme has been submitted to An Bord Pleanála for planning permission and if granted would bring in a significant sustainable transportation infrastructure needed for the area including improved pedestrian crossing facilities.

**Q.14 Councillor James Geoghegan**

Can the Manger report on the likely progress of the pedestrian crossing at Serpentine Avenue / Merrion Road as long sought by residents and Councillors?

**Reply:**

There is currently a signalised pedestrian crossing at this junction across the main road Merrion Road.

BusConnects proposes signalised pedestrian crossing facilities on all approaches to the junction, as below, and these would then operate as a dedicated phase/stage (wrap-around) pedestrian crossing movement.



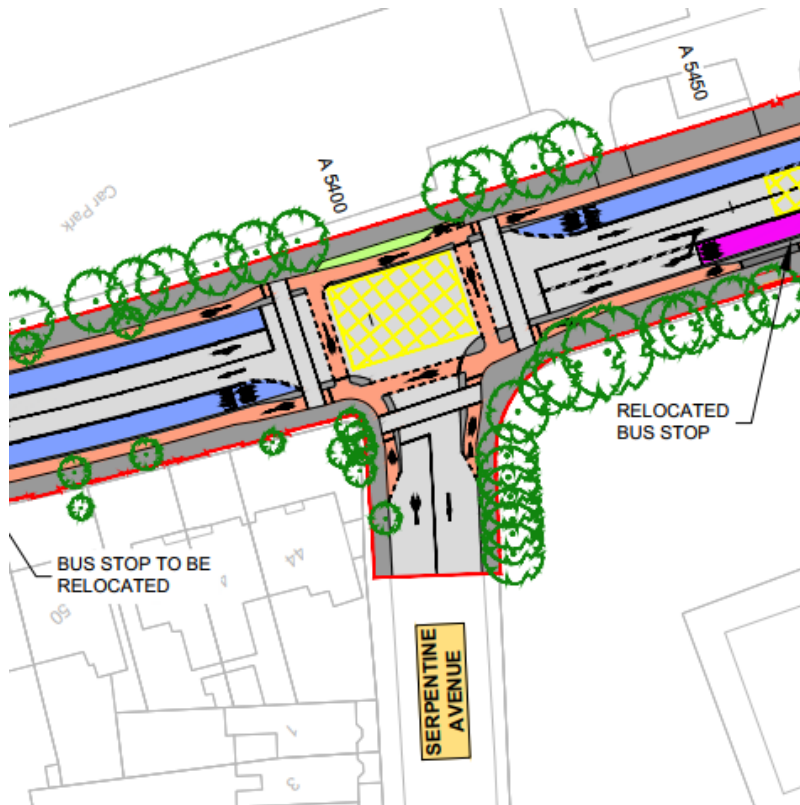

This proposal is part of the BusConnects CBC route14 / 15 Blackrock / UCD to City Centre. This scheme has been submitted to An Bord Pleanála for planning permission and if granted would bring in a significant sustainable transportation infrastructure needed for the area including improved pedestrian crossing facilities.

**Q.15 Councillor Tara Deacy**

Can I get an update on the status of 398 Clonard Road, neighbours have reported it is derelict and have not heard anything from DCC in regard to this?

**Reply:**

The Derelict Sites Unit is initiating formal action under the Derelict Sites Act 1990. An S.8 (2) Notice of Intention to enter the site on the Derelict Sites Register is due to be served on the owner who will have one month from the date of the Notice to make any representations against entry. Sites entered on the Derelict Sites Register are subject to a Derelict Sites Levy of 7% of market value. Outstanding levies also attract interest at the rate of 1.25% per month and outstanding levies including interest automatically become a charge on the land and will remain a charge on the land until all outstanding levies have been paid.

**Q.16 Councillor Tara Deacy**

Can the park / playground on Neagh Road, Terenure be locked by Dublin City Council at night; there is considerable anti-social behaviour occurring there and its closure has been requested by residents.

**Reply:**

Parks, Biodiversity and Landscape Services do not lock parks as per its policy unless is absolutely necessary. To facilitate this request it would require additional staffing resources at a time of constraint budgetary and staffing levels. The park is small in size and surrounded by road which allows Gardaí to carry out surveillance when patrolling. The residents are advised to immediately report any anti-social behaviour to the local Garda station so prompt actions can be undertaken.

**Q.17 Councillor Tara Deacy**

Why have we started to put this black tar like material at the bases of many trees in the area? Residents have brought this to our attention; is there a particular reason we are not using soil anymore?

**Reply:**

Road Maintenance Services usually carry out repairs adjacent to trees in a bituminous material. The flexibility of this material allows for tree roots to grow without causing cracking in the surrounding footpath.

The Parks Department has confirmed that most mature trees are not affected by this as they use their roots system to get water.

**Q.18 Councillor Tara Deacy**

A number of matches / training sessions for various local clubs have had to be cancelled in Bushy Park in recent weeks, as the pitches have been unplayable due to excess water from recent rainfall. I am aware that the pitches were either drained or treated last year to improve the condition. Could we find out the impact of that treatment and if there is more preventative work planned or possible to avoid the cancellation of such events for local clubs.

**Reply:**

The Grass Pitches are called off in situations where there are maintenance works needed to be done or due to the weather with persistent and / or heavy rainfall. Allowing play to go ahead would not have been appropriate as damage to pitches because of play during wet conditions would merely result in these pitches being called off for longer periods to affect repairs.

Drainage system has been installed on Grass Pitches No 2 and No 5 as part of the Pitch Improvement Works programme 2021/2022. These works helped with removing excess soil water quicker in order to reduce waterlogging and return soils to satisfactory playing surface for local clubs and schools who regularly use these facilities throughout the year.

**Q.19 Councillor Tara Deacy**

Myself, Cllr. Chu, Cllr. Freehill and Cllr. Lacey had requested that a review of pitch allocation and availability of playing pitches be carried out for the area. We had suggested this review ought to include all relevant stakeholders, did that ever happen?

**Reply:**

A meeting will be arranged with the Councillors mentioned to discuss the allocations and what stakeholders should be consulted.

**Q.20 Councillor Tara Deacy**

Can we get an update in relation to the digital advertisement in Rathmines? The issue continues to cause disruption to local residents, as no action seems to be planned or taken?

**Reply:**

The Planning Enforcement Section has carried out all relevant investigations at this site. We are waiting on the final report from our independent expert lighting consultant regarding the lighting levels from / at the sign measured on site. The Planning Enforcement Section will have the report early next week. What has been established and it will be documented in the report when received is that the lighting / illuminance levels as measured from the sign are now well within the limits / parameters outlined in the condition attached to the planning permission.

**Q.21 Councillor Tara Deacy**

When will the orcas / wands be reinstated in the 24-hour Cycle Lane in Harold's Cross? They were removed for building works but have yet to be replaced?

**Reply:**

These orcas at Harold's Cross were not removed by Dublin City Council. Replacements were installed on the 28<sup>th</sup> of October.

**Q.22 Councillor Tara Deacy**

Can the manhole with a broken hinge be replaced ASAP at details supplied before it causes a serious accident?

**Reply:**

This gully was repaired by DCC Drainage Division on Thursday 27<sup>th</sup> October last.

**Q.23 Councillor Tara Deacy**

Could the relevant staff of DCC (Traffic / Roads) facilitate a meeting with the Principal of St. Louis Infant and Senior Primary School to try and reach some resolution or assist in some way to address the on-going dangerous nature of school drop off and pickups faced by parents, staff and very young children on a daily basis.

**Reply:**

The School Mobility Officer has made contact with the Parents association. She will conduct observations of their current assistance of children on their school journey. This meeting will happen in the coming weeks. The school has received a School Zone and this observation will be used to see how it can be improved upon.

**Q.24 Councillor Paddy McCartan**

To ask the Manager to respond to the following issue from a constituent, who writes:

"The major construction work ongoing at Tom Johnson house, Beggars Bush.

The noise and disruption coming from the site has become a very significant issue affecting the neighbourhood, myself in particular. The building began during the early part of this year and is planned to last until late 2023 at the earliest. I own and live in an apartment just a few feet from the construction site (where work begins at 7am every day and only finishes around 6pm). The noise has unfortunately become extremely intrusive, including a lot of jack hammering and heavy impact noises (involving concrete breaking, among others). Sometimes work takes place on Saturdays also. It became particularly troublesome from the summer months onwards, when jackhammers were going off from 7am, sometimes all day long. No notice was given for any of this and residents were not consulted on any of the works.

Many of the residents here work from home (and many are also retired) and struggle to carry out their work or are unable to do so. Quite a few have young children also. I have recently started a professional training course at the Kings Inns which is being delivered 60% remotely (from home) and I just can't carry out the work I need to do or the classes from my home because of the noise. I have nowhere else to go, leaving me only with the option of leasing expensive office space or moving house which seems unlikely in the housing crisis we're in.

I have contacted Dublin City Council with little success other than to confirm that planning permission was not required.

I have also contacted the construction company (Duggan), with no actual follow-up or progress. I understand the work was ordered by the OPW and that the building is owned by the Minister for Finance (although I'm not 100% sure on the last point).

**Reply:**

The issues raised by the Councillor will be investigated fully by the Planning Enforcement Section and appropriate action will be taken if it is determined that any planning related infractions are occurring on site.



**Q.25 Councillor Paddy McCartan**

To ask the manager to respond to the following issue from a constituent, who writes:

"I live on Park Avenue, Sandymount and would like to bring to your attention the disgusting quality of the drinking water in the area. Below are photos of the water filter that we installed – the photo on the left was taken after putting a new filter in, the middle photo was taken a couple of hours later, and the one on the right was taken the following day. These highlight the significant level of dirt in the water.

I have written to Irish Water about it but to no avail, and I'm aware that considerable mains water works have been done in the area recently, which I would have thought would have rectified the issue. However, I'm very concerned about the water quality given how quickly dirt builds up in the filter, resulting in it having to be changed every week, at a cost of €10 per filter! We have now had to revert to buying drinking water at considerable expense. Moreover, I would worry for my fellow residents that don't have a filter on their water and are probably unaware of how dirty the water that they're drinking is.

See pic below



[Note only the photograph above was received by the South East Area Office.]

**Reply:**

This query should be directed to Irish Water who in turn should generate a work-order for investigation of the suspected water-quality issue.

Notwithstanding the above, there is still quite a lot of 100+ year old Cast Iron water mains in use in the Sandymount area (including Park Avenue). Over time, Iron encrustation / tuberculation can form on the internal walls of said water-mains. Occasionally, this material can get disturbed (e.g. if there is an isolation / depressurisation for leak-repairs). When this occurs, the issue can present itself as brown-water at cold kitchen taps.

The permanent solution to this problem is rehabilitation of the water-mains. However, as there are ~1000 km of Cast Iron mains in the DCC area, it will be some time before all are replaced.

As an interim measure, we will arrange for the fire hydrants in the vicinity of Park Avenue to be flushed until the water runs clear.

**Q.26 Councillor Paddy McCartan**

To ask the manager to deal with the following issue from a constituent, who writes:

"I'm a resident of Serpentine Park, Sandymount and I wish to voice my concerns over the current traffic management issues in the area.

The works being performed by Irish Water coupled with the increased frequency of DARTs causing the tracks to almost continuously be closed has resulted in gridlock in a residential area.

Motorists are becoming understandably frustrated and are now driving down wrong side of road and skipping queues of traffic in an attempt progress on the journeys.

There are many vulnerable people living in the areas. Children going to school and elderly people trying to run errands are being put at huge risk and a severe accident is waiting to happen. I have witnessed several near misses and have also seen the DART lines being rammed and driven through on two separate occasions by large vehicles out of pure frustration. This situation is becoming worse and worse."

**Reply:**

The following response has been received from Irish Water:

"Thank you for your query regarding the works currently in progress at Beach Road / Strand Road, Sandymount.

The main diversion route for through traffic in operation diverts southbound traffic onto Tritonville Road and Serpentine Avenue. We acknowledge that the volume of traffic using these streets has increased accordingly. The pipe laying works and phased lane closure, as of today Thursday 11<sup>th</sup> Nov, are now located between Marine Drive to Newgrove Avenue. This change of location will allow local traffic to turn left once again off Sean Moore Road and towards Strand Road, whilst utilising a localised diversion around our works. This should reduce the amount of cars utilising Cranfield Place and Tritonville Road / Serpentine Avenue. We would expect as our work zone moves, in a phased manner, away from the junction of Sean Moore Road / Beach Road that associated traffic volumes on Tritonville Road / Serpentine Avenue will reduce.

Traffic management is required to ensure the safety of the workforce and road users. The construction works necessitate extensive, and on occasions complicated, Temporary Traffic Management Schemes. For these reasons special care is taken to ensure Traffic Management is constantly monitored and adjusted where necessary and safe to do so. To this end all Traffic Management Schemes are coordinated with input from consultees including An Garda Síochána and Dublin City Council and are monitored regularly.

Following feedback from all stakeholders and a further review of site conditions the traffic management plans are currently under review with Dublin City Council and our contractor completing the works to identify any alternative / additional Traffic Management measures that could be implemented to improve the situation. Some minor local solutions have already been implemented since the commencement of the project. Proposed major changes and/or phased changes to the traffic management plans will continue to be communicated out to the public via our normal communications channels.

We would like to extend thanks to the local community, residents, homeowners, businesses and commuters for their patience and cooperation while these works are completed. The latest project sheet is attached for more information."

**Q.27 Councillor Paddy McCartan**

To ask the manager to deal with the following issue from a constituent, who writes:

"As a local resident, I wish to complain about the hazardous situation that has been created by traffic being deliberately diverted down Tritonville Road and Serpentine Avenue due to

works being carried out by Irish Water on Strand Road as a result the serious congestion that is being caused.

There are tailbacks at the level crossing on Serpentine Avenue and Tritonville Road morning, noon and night, including at weekends since Irish Water started work on the Strand Road last week. (There has yet to be a big event at the RDS or Aviva which will add to the chaos when it takes place e.g. upcoming Ideal Homes at the RDS).

It is very difficult to cross Serpentine Avenue and Tritonville Road with the constant flow of traffic over the past week and particularly hazardous for children and the elderly.

Due to their pent up frustration, cars and vans are trying to make it through the level crossing on Serpentine when there is not enough time to do so. Neighbours have witnessed the crossing being rammed and driven through on two occasions by frustrated van drivers. You can check this with Irish Rail (and while you are at it you might try to find out from them why the level crossing gates are always left down for such long periods of time). Even more worryingly, drivers coming from Tritonville are now using the wrong side of the road as it approaches the roundabout at Claremont Road / Serpentine Road to escape out of the tailback from the crossing. There have been two near misses reported by neighbours at the roundabout beside us in recent days. An elderly neighbour (87) who has to visit her sister in a nursing home at Roebuck 4 times a week is very upset as she can't get out of Serpentine Park onto Tritonville Road and is delayed for long periods of time in both directions at the Serpentine Avenue level crossing on every journey.

Another elderly lady (93) lives just before the level crossing on the Tritonville side and she cannot get her car out to go to mass and for her messages. Far more cars than usual are now sitting idling for long periods of time on Serpentine Avenue and Tritonville Road causing serious pollution which is directly damaging the health of pedestrians, cyclists and residents, never mind the mental stress that is being caused to all of the above by this. The works only started last week on Strand Road so clearly the above will represent the tip of the iceberg as regards the issues that are going to be caused by this serious congestion as we head into the winter months.

Can you please confirm how long this serious traffic congestion is going to continue and what steps DCC will take to alleviate it to ensure that a serious accident does not take place?"

**Reply:**

The following response has been received from Irish Water:

"Thank you for your query regarding the works currently in progress at Beach Road / Strand Road, Sandymount.

The main diversion route for through traffic in operation diverts southbound traffic onto Tritonville Road and Serpentine Avenue. We acknowledge that the volume of traffic using these streets has increased accordingly. The pipe laying works and phased lane closure, as of today Thursday 11<sup>th</sup> Nov, are now located between Marine Drive to Newgrove Avenue. This change of location will allow local traffic to turn left once again off Sean Moore Road and towards Strand Road, whilst utilising a localised diversion around our works. This should reduce the amount of cars utilising Cranfield Place and Tritonville Road / Serpentine Avenue. We would expect as our work zone moves, in a phased manner, away from the junction of Sean Moore Road / Beach Road that associated traffic volumes on Tritonville Road / Serpentine Avenue will reduce.

Traffic management is required to ensure the safety of the workforce and road users. The construction works necessitate extensive, and on occasions complicated, Temporary Traffic Management Schemes. For these reasons special care is taken to ensure Traffic Management is constantly monitored and adjusted where necessary and safe to do so. To

this end all Traffic Management Schemes are coordinated with input from consultees including An Garda Síochána and Dublin City Council and are monitored regularly.

Following feedback from all stakeholders and a further review of site conditions the traffic management plans are currently under review with Dublin City Council and our contractor completing the works to identify any alternative / additional Traffic Management measures that could be implemented to improve the situation. Some minor local solutions have already been implemented since the commencement of the project. Proposed major changes and/or phased changes to the traffic management plans will continue to be communicated out to the public via our normal communications channels.

We would like to extend thanks to the local community, residents, homeowners, businesses and commuters for their patience and cooperation while these works are completed. The latest project sheet is attached for more information."

**Q.28 Councillor Paddy McCartan**

To ask the Manager to respond to the following issue from a constituent, who writes:

"I am a parent of students in St. Christopher's Primary School in Dublin 4. I am emailing you today to raise my concerns around children's safety on school pick up and drop off in relation to traffic. I find Haddington Place to be very problematic. This is a 2 way lane but in reality there is only space for one car to pass since there are car parking spaces. As a result, this lane gets always very congested, with cars queueing to get in and out of the lane either into Haddington Road or into St. Mary's Road. There are parents with young children crossing the lane and I find it very dangerous with all the cars piled up and blocking the way. I myself have experienced near hits with my own children.

I am a huge advocate of pedestrianising Haddington Place to cars and making it accessible only to residents. Most of the residents live on St. Mary's Lane, which would be residents only as well and could be used for them to exit into St. Mary's Road. And I am sure that a solution can be found for the car access to the Sisters and the 2 houses next to school on Haddington Place.

I understand from our principal that discussions on the topic have taken place as early as 2019 but nothing has changed since. I would appreciate if you could raise the topic in any relevant meetings that you attend so action is taken."

**Reply:**

The School Mobility Officer has completed school gate observations for St. Christopher's Primary School at the school's request because of the volume of traffic converging on small lanes next to the School's side entrances which the School Principal deemed a serious safety for all children exiting and entering the school.

Green Schools have completed and submitted

- Walkability audit report for St. Christopher's P.S., Haddington Road.
- We have invited St. Christopher's to do the Parent Travel Survey.

The laneway is currently being assessed for suitability as a "School Street". An update will be provided to Councillors on the proposals for this school once the design proposal has been completed.

**Q.29 Councillor Paddy McCartan**

To ask the Manager to respond to the following from SAMRA (Sandymount & Merrion Residents' Association):

“Recently, SAMRA conducted a survey to understand the extent to which footpath parking was seen as a problem by local residents, which streets are most affected, and what people would like done about it. I've attached the short report on it here, but some highlights are:

- There are *many* streets in Sandymount where residents have been negatively affected by footpath parking
- Having cars parked on the footpaths creates an unsafe environment, forcing people have to walk on the road or being unable to go on certain streets
  - This particularly negatively affected people with mobility impairments, people pushing buggies, and young children
- No one completing the survey said that this wasn't an issue in the area

As a residents' association, we do not have the resources or ability to prevent footpath parking in the area. I am therefore writing to you as our local councillor, to ask if you can work proactively towards solutions to this problem. A mixture of education (putting flyers in the windscreens of cars) and enforcement (asking An Garda Síochána to ticket people for this) were suggested, along with larger changes like painting parking bays on certain roads. What would you suggest for moving this forward? Is there something you can do to help us address this problem?”

**Reply:**

**Footpath Parking – September 2022**

The Transport Advisory Group inspected the Streets which residents highlighted as having a significant issue with footpath parking.

- **Durham Road**

Transport Advisory Group investigated, noted cars park on west side of Durham Rd / Gilford Road especially at school opening / closing hours.

The local residents of the road should apply Pay & Display & Permit parking which would help formalise the parking on the street.

See the criteria and how to apply for scheme here

<https://www.dublincity.ie/residential/parking-dublin-city-centre/start-parking-scheme>

It was observed vehicles parking on Durham Rd /Newgrove Ave private landing which is not in charge by Dublin City Council and cannot be enforced

- **Gilford Road**

Transport Advisory Group investigated and did not notice vehicles parking on footpath. However the local residents of the road should apply for Pay & Display & Permit parking which would help formalise the parking on the street.

See the criteria and how to apply for scheme here

<https://www.dublincity.ie/residential/parking-dublin-city-centre/start-parking-scheme>

- **Gilford Drive**

Transport Advisory Group investigated and did notice vehicles parking on footpath. However the local residents of the road should apply for Pay & Display & Permit parking which would help formalise the parking on the street.

See the criteria and how to apply for scheme here

<https://www.dublincity.ie/residential/parking-dublin-city-centre/start-parking-scheme>

- **Strand Road**

Transport Advisory Group investigated and did not notice vehicles parking on footpath.

- **Beach Road**

Transport Advisory Group investigated and did notice vehicles parking on footpath near Sean Moore Park.

- **Sandymount Green**

Transport Advisory Group investigated and did not notice vehicles parking on footpath.

- **Seafort Avenue**

Transport Advisory Group investigated and did not notice vehicles parking on footpath. This is a Pay & Display & Permit parking area and vehicles seem to abide by the formal parking.

- **Oswald Road**

Transport Advisory Group investigated and did not notice vehicles parking on footpath, but further investigation should be made during school opening / closing times of St Matthews National School.

However the local residents of the road should apply for Pay & Display & Permit parking which would help formalise the parking on the street.

See the criteria and how to apply for scheme here

<https://www.dublincity.ie/residential/parking-dublin-city-centre/start-parking-scheme>

It should be noted that the road being narrow could only allow one sided parking.

- **Park Lane**

Transport Advisory Group investigated and did notice vehicles parking on footpath.

However the local residents of the road should apply for Pay & Display & Permit parking which would help formalise the parking on the street.

See the criteria and how to apply for scheme here

<https://www.dublincity.ie/residential/parking-dublin-city-centre/start-parking-scheme>

- **Park Avenue**

Transport Advisory Group investigated and did notice commercial vehicles parking on footpath on the south side of Park Avenue near the intersection Sydney Parade Avenue.

- **Lea Road**

Transport Advisory Group investigated and did notice vehicles (possibly residents) parking on footpath on the south side of Lea Road.

However the local residents of the road should apply for Pay & Display & Permit parking which would help formalise the parking on the street.

See the criteria and how to apply for scheme here

<https://www.dublincity.ie/residential/parking-dublin-city-centre/start-parking-scheme>

It should be noted that the road being narrow could only allow one sided parking.

- **Wilfield Road**

Transport Advisory Group investigated and did notice vehicles (possibly residents) parking on footpath on the south side of Wilfield Road.

However the local residents of the road should apply for Pay & Display & Permit parking which would help formalise the parking on the street.

See the criteria and how to apply for scheme here

<https://www.dublincity.ie/residential/parking-dublin-city-centre/start-parking-scheme>

It should be noted that the road being narrow could only allow one sided parking.

- **Sydney Parade Avenue**

Transport Advisory Group investigated and did not notice vehicles parking on footpath

- **Marine Drive**

Transport Advisory Group investigated and noted cars park on footpath near the side of Tesco on Marine Drive.

It also observed vehicles parking on private landing near side of Tesco which is not in charge by Dublin City Council and cannot be enforced.

- **Tritonville Road**  
Transport Advisory Group investigated and did not notice vehicles parking on footpath.
- **Serpentine Avenue**  
Transport Advisory Group investigated and did not notice vehicles parking on footpath.
- **Serpentine Park**  
Transport Advisory Group investigated and did not notice vehicles parking on footpath.
- **Serpentine Road**  
Transport Advisory Group investigated and did not notice vehicles parking on footpath.

The Transport Advisory Group will pass on our observations on each of the above streets to the Parking Enforcement Team to monitor.

**Q.30 Councillor Paddy McCartan**

To ask the Manager to deal with the following issue on Tritonville Road Sandymount:

“This morning and today have large trucks racing up and down our road. Is this not illegal? What can we do about this or does DDC not care? This rerouting of large scale traffic onto already busy roads. They could have kept Strand road open and had a stop go system.”

**Reply:**

The 5+ axle HGV cordon covers the area of Tritonville Road. The hrs of operation were recently extended to become 24hrs. Only 5+ axle HGVs delivering inside the cordon area should be operating on Tritonville Road.

A request has been made to An Garda Síochána to carry out enforcement on Tritonville Road.

Irish Water did consider the implementation of a Stop-Go system on Strand Road to accommodate the works. However, due to the length of the work-site (>200m), in conjunction with multiple side-roads, this would result in significantly more congestion than the current diversion system.

I'd suggest that the Councillor contacts Irish Water directly through their dedicated Elected Representatives channels:

The Local Representative Support Desk at Irish Water operates from 9.00am – 5.30pm, Monday to Friday.

The following are the contact details for Irish Water:

Telephone:	<a href="tel:0818178178">0818 178 178 / 0818 578 578</a>
Web:	<a href="http://www.water.ie">www.water.ie</a>
Twitter:	@IrishWater
Postal Address:	Irish Water, PO Box 860, South City Delivery Office, Cork City.
Email:	<a href="mailto:localrepsupport@water.ie">localrepsupport@water.ie</a>

**Q.31 Councillor Paddy McCartan**

To ask the Manager to respond to the following email from a concerned resident:

“In light of the traffic diversions directed up Tritonville Road / Serpentine Avenue due to closure of south bound lane on Strand Road, the volume of traffic coming up through these roads is now all day every day and what was a dangerous junction at Serpentine Avenue / Merrion Road due to no pedestrian lights, is now a lethal junction, traffic turning left is backed

up most of the day down Serpentine / Tritonville and because cars have been held either by Dart track barriers being down or because of slow pace of traffic coming up small residential streets such as Tritonville, they are in no mood to stop for a pedestrian.

I contacted DCC on January 15th 2001 and was informed at that time that 'a design process for a pedestrian crossing at Serpentine Avenue is currently underway'.

DCC however then changed this in April of 2021 to a pedestrian crossing not being recommended due to Bus Connects / Strand Road cycle lane.

I find it difficult to comprehend that DCC have allowed such traffic diversion to be put in place whereby such a volume of cars are fed into this junction without properly addressing the impact on pedestrians / cyclists.

It is wilful negligence and as for the notion of 'traffic evaporation' I would just like to ask any of you to stand at the top of this junction to see the nonsense of such a theory.

I call upon DCC to do their job and properly ensure the safety of pedestrians / cyclists who are now running the gauntlet; some cyclists now have to resort to going up on the path midway up Serpentine as there is no room on the avenue to pass between stalled traffic and parked vehicles.

I cannot begin to tell you how remiss it is of DCC and truly one can only come to the conclusion that DCC are trying to exact revenge on residents who have quite rightly called DCC to account in relation to 'Sandymount Cycle Trial' currently before the courts."

**Reply:**

The Traffic Management in question is associated with the rehabilitation of the water main on Strand Road by Irish Water.

All queries should be directed to the following Irish Water contacts provided to DCC for the purpose of dealing with complaints from the public:

- Declan Healy ([dehealy@water.ie](mailto:dehealy@water.ie));
- Matthew Thomson ([mthomson@water.ie](mailto:mthomson@water.ie));

Alternatively the Local Representative Support Desk at Irish Water operates from 9.00am – 5.30pm, Monday to Friday.

Telephone: [0818 178 178 / 0818 578 578](tel:0818178178)

Web: [www.water.ie](http://www.water.ie)

Twitter: @IrishWater

Postal Address: Irish Water, PO Box 860, South City Delivery Office, Cork City.

Email: [localrepsupport@water.ie](mailto:localrepsupport@water.ie)

It should be noted that there is currently a signalised pedestrian crossing at this junction across the main road Merrion Road. There was plans originally to upgrade this in conjunction with the Strand Road cycle trial and funded by the NTA, however this was put on hold due to the Court case and the funding was no longer available. Instead the upgrade of this junction has been incorporated into the Bus Connects proposal for the Merrion corridor.

BusConnects proposes signalised pedestrian crossing facilities on all approaches to the junction, as below, and these would then operate as a dedicated phase/stage (wrap-around) pedestrian crossing movement.



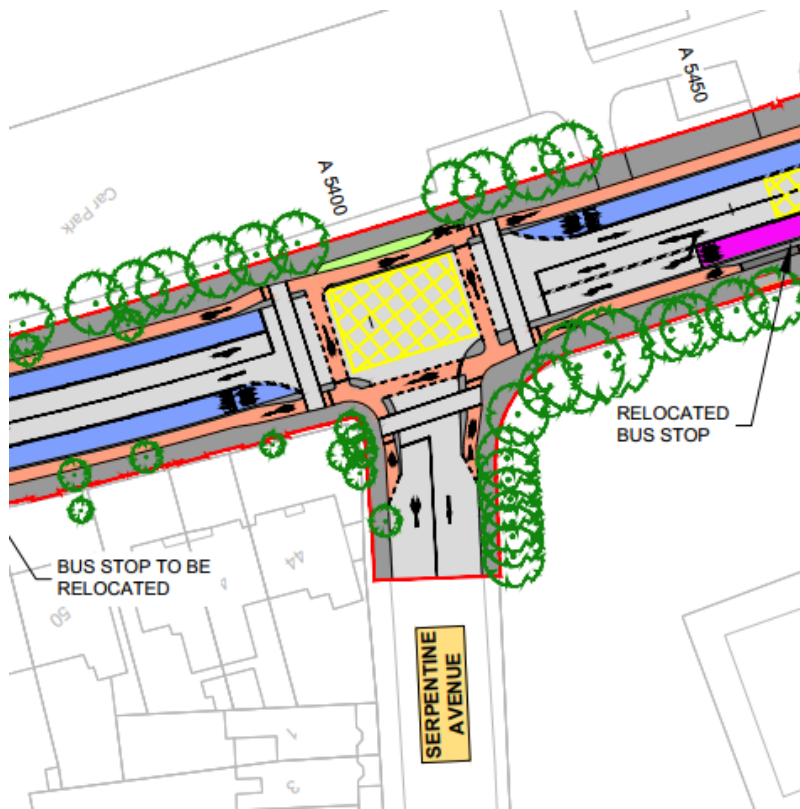

This proposal is part of the BusConnects CBC route 14/15 Blackrock/UCD to City Centre. This scheme has been submitted to An Bord Pleanála for planning permission and if granted would bring in a significant sustainable transportation infrastructure needed for the area including improved pedestrian crossing facilities.

**Q.32 Councillor Paddy McCartan**

To ask the manager to deal with the following issue from a constituent:

"I just want to update you on traffic issues in this area following changes to traffic on Belmont Avenue.

I live off Marlborough Road and walk up and down the road several times a day and I do this every day. Since the traffic changes on Belmont Avenue, the following has happened on Marlborough Road:

At rush hour times, traffic is backed up for the entire length of Marlborough Road and is also backed up on Sandford Road and the corresponding access roads to Marlborough in the mornings and evenings.

There is no room for cyclists on Marlborough Road when there is two way traffic and it is very dangerous for cyclists on the road at rush hours. As a result, cyclists are constantly on the footpaths which are already full with adults and children going to and from the schools in the area and people going to and from work. This is obviously dangerous for the pedestrians, especially small children, who are being pushed aside as cyclists barge through.

I have personally seen numerous cars and trucks go up on the footpaths (especially the one coming down Marlborough Road from Sandford Road) during busy traffic times because there is not enough room for two way traffic. This is highly dangerous and the Belmont Avenue problems (which needed to be dealt with) have simply been shifted on to Marlborough Road as anticipated.

An overall traffic solution for the whole area needs to be found rather than piecemeal attempts being made to deal with it. I would therefore be grateful if you could consider these issues and include them in any representations you are making on the traffic issues in the area."

**Reply:**

Please find the response to the Councillor's question as provided by the external consultant who is responsible for the design of the Restricted Access scheme on Belmont Avenue:

*"Thank you for the comments and observations.*

*The measures implemented are on a trial basis, during this period we are monitoring changes to traffic movement in the surrounding roads / streets and junctions.*

*The feedback we have received thus far has been largely positive. We acknowledge there are some consequences to the changes.*

*Unfortunately, we cannot control cyclists using the footpath as you have outlined prior to this scheme being in place or after it. Similarly we cannot prevent vehicles mounting the footpath without the provision of physical measures.*

*Where the scheme is to be made permanent, additional measures on surrounding roads and streets will be investigated also that may need to be done in parallel to making the scheme final and permanent on Belmont Avenue."*

**Q.33 Councillor Paddy McCartan**

To ask the Manager to deal with the following issue from a constituent:

"I am writing to you and a few other Pembroke East council members about the disastrous traffic planning for the Beach Road, Sandymount (R802) roadworks. I accept that the water main replacement needs to go ahead, and I am sure there is a good reason they couldn't lay the pipe in the adjacent Sean Moore Park.

However the traffic planning on the project, this week in particular has been disastrous. Tailbacks along Sandymount Road all the way to the Green, frustrated, angry drivers, delayed buses and terrible air pollution for cyclists and walkers. This all could be avoided with basic manned traffic controls at the Tritonville and Church Avenue junction to facilitate traffic turning right and traveling North, and additional manned traffic controls to enable traffic heading south to exit from Beach road (R802) onto Church Avenue without blocking the junction for cars heading north along R802. Overall this is a totally shambolic situation. Could you please inquire if the traffic controls could be amended to help address this situation in anyway?

Also how long is this phase of the works likely to go on?

Finally is this how the long term traffic planning for this area will evolve if the City Managers Beach Road cycle lane plan goes ahead? If so, I expect the issue will become a local political lighting rod.

Hopefully you can provide some guidance on the situation as it really is causing a lot of unnecessary misery, and I say this as someone who only drives once a week!"

**Reply:**

The following response has been received from Irish Water:

"Thank you for your query regarding the works currently in progress at Beach Road / Strand Road, Sandymount.

The main diversion route for through traffic in operation diverts southbound traffic onto Tritonville Road and Serpentine Avenue. We acknowledge that the volume of traffic using these streets has increased accordingly. The pipe laying works and phased lane closure, as of today Thursday 11<sup>th</sup> Nov, are now located between Marine Drive to Newgrove Avenue. This change of location will allow local traffic to turn left once again off Sean Moore Road and towards Strand Road, whilst utilising a localised diversion around our works. This should reduce the amount of cars utilising Cranfield Place and Tritonville Road / Serpentine Avenue. We would expect as our work zone moves, in a phased manner, away from the junction of Sean Moore Road / Beach Road that associated traffic volumes on Tritonville Road / Serpentine Avenue will reduce.

Traffic management is required to ensure the safety of the workforce and road users. The construction works necessitate extensive, and on occasions complicated, Temporary Traffic Management Schemes. For these reasons special care is taken to ensure Traffic Management is constantly monitored and adjusted where necessary and safe to do so. To this end all Traffic Management Schemes are coordinated with input from consultees including An Garda Síochána and Dublin City Council and are monitored regularly.

Following feedback from all stakeholders and a further review of site conditions the traffic management plans are currently under review with Dublin City Council and our contractor completing the works to identify any alternative / additional Traffic Management measures that could be implemented to improve the situation. Some minor local solutions have already been implemented since the commencement of the project. Proposed major changes and/or phased changes to the traffic management plans will continue to be communicated out to the public via our normal communications channels.

We would like to extend thanks to the local community, residents, homeowners, businesses and commuters for their patience and cooperation while these works are completed. The latest project sheet is attached for more information."

**Q.34 Councillor Paddy McCartan**

To ask the manager to respond to the following issue from a constituent, who writes:

"The drains on Church Avenue and Bath Street seem to be constantly blocked and, whenever there is the slightest bit of rain, both roads are flooded. You can imagine how bad it is today in the heavy rain. I have raised this in the past with Dublin City Council, and asked for it to be brought to Owen Keegan's attention as I got no response elsewhere, but have had no update or seen any action. With the additional traffic now on these roads, the situation has worsened and the risk of being soaked by passing vehicles has increased significantly. At times it is virtually impossible to cross Bath Street.

Could you please raise this with the council, as it is in need of urgent attention? Hopefully you will be able to have some impact and create some action, where I have failed."

**Reply:**

Church Avenue and Bath Street are roads that are on a rotational area in Sandymount which is cleaned up to three times per year.

The five gullies on Church Avenue were cleaned in July 2022. An inspection was carried out on foot of this query and it was found that although there was debris sitting on top of the gullies, they were operational and clean.

Ten out of the thirteen gullies were cleaned in September 2022. Parked cars prevented a clean sweep. These gullies were also checked today and again did not need to be cleaned but had debris removed from the grids of the gullies.

Since 2004 Church Avenue have been checked / cleaned on 105 occasions.  
Since 2004 Bath Street have been checked / cleaned on 103 occasions.

There are two reported repairs in this area, one on Church Avenue and one on Bath Street. Repairs at these locations are not straightforward due to traffic management and the presence of high tension ESB cables. Drainage Maintenance are examining how best to facilitate a repair.

**Q.35 Councillor Kevin O'Donoghue**

To ask the Manager to convene a meeting between SEIC & NEIC councillors and relevant JPCs to discuss the issue of anti-social behaviour occurring in City Quay.

**Reply:**

The Bridge Project which was set up in early 2022 is an interagency approach with the objective of bridging the divide between young people from the areas north and south of the River Liffey and will focus primarily on anti-social behaviour in the George's Dock / City Quay Area. Both the Area Managers from the South East Inner City & Pembroke and also the North Inner City Area have recently joined this project and are working with key stakeholders including youth services north and south of the Liffey, An Garda Síochána from both Store Street and Pearse Street and local schools. Councillors from the SEIC & NEIC will be kept fully informed of progress.

**Q.36 Councillor Kevin O'Donoghue**

To ask the Manager to liaise with relevant departments about the clean-up of carrion along Sandymount Strand.

**Reply:**

Parks Services have been routinely checking on beaches at Sandymount Strand and Merrion Gates since October 20<sup>th</sup> to remove and dispose any carcasses that may be found.

Biosecurity protocols are being followed to ensure staff safety and prevent further spread of avian influenza (H5N1). Parks, Biodiversity and Landscape Services have also been liaising with the Veterinary Pathologist at the Department of Agriculture, Food and the Marine and recording the birds found.

**Q.37 Councillor Kevin O'Donoghue**

To ask the manager if it would be possible to apply to participate in the zebra crossing pilot programme recently announced by Government and specifically if Camden Street could be considered for this pilot.

**Reply:**

Currently DCC is not participating in the government trial for the installation of zebra crossing without Belisha beacons. A subcommittee of the transport SPC is currently reviewing the possibility of installing additional standard zebra crossing in the DCC area.

**Q.38 Councillor Kevin O'Donoghue**

To ask the Manager to investigate an increase in illegal parking in Byrne's Lane Dublin 2.

**Reply:**

Dublin Street Parking Services will be requested to patrol this location and enforce any illegal parking observed.

**Q.39 Councillor Kevin O'Donoghue**

To ask the manager to have the double yellow lines in Byrne's Lane in Dublin 2 repainted.

**Reply:**

The location will be inspected in the coming days. Any requirement for re-painting will be tasked within 30 working days of the SEAC meeting of the 14/11/22.

**Q.40 Councillor Daniel Ceitinn**

To ask the Manager to examine the feasibility of installing a south-bound right-turn lighted filter at the junction of R111 and R118 to facilitate smoother traffic flow travelling east along R111 and turning right south-bound on R118.

**Reply:**

A review of the traffic signal operation at this site was carried out, the right turn movements from the R111 to the R118 accounts for approximately 11% of the total traffic at this junction.

The addition of a right turn filter traffic phase at this site would result in delays to public transport along Northumberland Road and is not recommended at this time.

**Q.41 Councillor Daniel Ceitinn**

To ask the Manager to examine the installation of speed-bumps and 'children at play' signs on Devenish Road and Kilfenora Road in Dublin 12.

**Reply:**

The Area Engineer will request a speed survey on Devenish Road and Kilfenora Road in order to assess if speed ramps are required.

**Q.42 Councillor Daniel Ceitinn**

To ask the Manager if a dedicated filter right turn could be installed for traffic coming from Kimmage Road Lower (city centre direction) onto Sundrive Road.

**Reply:**

Due to the road layout it is not possible to install right turn filter signal from Kimmage Road Lower on to Sundrive Road, as there is not sufficient space for a right turning only lane as there is only one lane and an advisory cycle lane on Kimmage Road lower.

**Q.43 Councillor Daniel Ceitinn**

To ask the Manager whether additional supports could be provided by Dublin City Council to the upgrades of facilities for Harold's Cross Youths FC at Paddy Brennan Rosary Park, Dublin 6.

**Reply:**

An update in relation to this issue is given in the Director's report every month and the members of the Kimmage Rathmines ward are frequently updated. At the last area meeting the six members of the Kimmage Rathmines ward and the Chair of the Committee requested a meeting with the Chief Executive in relation to this matter. The full Committee will be updated in relation to any progress.

The Area Manager also continues to work closely with the Harold's Cross Football Club and the Property Management Section / Law Department in relation to finalising the Lease.

We have a regular grant available for clubs that cater for Youth the Sport for Young People grant.

The club received the grant in 2020 & 2021 but there was no application from them for 2022 and it is now closed.

Notification was sent to all clubs on our mailing list re the grants in July.

They have also received Covid support funding from the South East Area Office.

**Q.44 Councillor Daniel Ceitinn**

To ask the Manager when the extension for Ringsend Community Crèche will be in place and who is responsible for delivering this particular project.

**Reply:**

Dublin City Council have no direct role in this crèche development. A commitment has been given to an element of funding here and we will follow through on that commitment before Christmas.

**Q.45 Councillor Daniel Ceitinn**

To ask the Manager if the provision of a closed-in bin facility area in Bishop Street Flats could be developed, and when is it anticipated that this might be done.

**Reply:**

Housing Maintenance has commenced a new programme of installing secure segregated bin areas and our intention will be to include, where possible, all of our housing complexes. These new bin areas have multiple benefits both for our tenants and the environment in which they live. We are currently engaging with tenants on a project in the South East Area and will progress onto construction whenever that process is complete.

Although Bishop Street is not in the first phase, as soon as we have completed the initial lists for all the respective Council areas, we will then extend the programme and we are happy to consider Bishop Street as part of the next phase.

**Q.46 Councillor Daniel Ceitinn**

To ask the Manager if he will ensure general maintenance for an area at the rear of an address (details supplied) including grass cutting, weeding, and removal of moss etc. and a power wash.

**Reply:**

Housing Maintenance Southside Mobile Crew removed graffiti, trimmed shrubs and removed weeds at this location at the request of the South East Area Housing Manager in January 2022 and have added it to their list of works and will endeavour to carry out these further works shortly.

**Q.47 Councillor Daniel Ceitinn**

To ask the Manager if the trees at the green at Larkfield Gardens, at the rear of Beech Hill Villas (due to anti-social behaviour as the trees are blocking street lights) and on Sundrive Road (between the Stannaway Road and Blarney Park junctions) could be pruned.

**Reply:**

The trees at (details supplied) will be inspected in the coming weeks as local schedules allow and any works deemed necessary will be listed for inclusion in the prioritised tree care programme for the area 2022-23.

**Q.48 Councillor Daniel Ceitinn**

To ask the Manager if the trees on the Ross Road and within the complex at Nicholas Street could be pruned, in particular the tree blocking the balcony of details supplied.

**Reply:**

The trees at Ross Road will be inspected in the coming quarter as schedules allow and any works deemed necessary will be listed for inclusion in the prioritised tree care programme for the area 2022-23.

Pruning of the trees in Ross Road Complex is on the list of works of the Housing Maintenance Southside Mobile Crew and this will be attended to in the near future.

**Q.49 Councillor Daniel Ceitinn**

To ask the Manager if the tree which is cracking the front wall of details supplied could be either removed or treated.

**Reply:**

The tree at (details supplied) will be inspected in the coming weeks as local schedules allow and any works deemed necessary will be listed for inclusion in the prioritised tree care programme for the area 2022-23.

**Q.50 Councillor Daniel Ceitinn**

To ask the Manager if a meeting could be facilitated between Parks Department, South East Area management and residents of Kerlogue Road, Ringsend, D4 who have longstanding issues with overgrown trees on their road.

**Reply:**

South East Area Office can contact undersigned to arrange the meeting as requested.

**Q.51 Councillor Claire Byrne**

To ask the Area Manager can he please plant trees on Harcourt Terrace?

**Reply:**

Dublin City Council Parks, Landscape and Biodiversity Department is currently concentrating on planting of street trees within areas of the city identified with a deficit of tree canopy cover such as areas covered by our Liberties greening, Stoneybatter and North East Inner city Greening Strategies. The area of Harcourt Terrace is not identified as such an area and is currently not on our priority list.

**Q.52 Councillor Claire Byrne**

To ask the Area Manager if he will examine and issue a report on sustained levels of flooding on Grand Canal Street Upper and what action will be taken to this ongoing threat to health and safety.

**Reply:**

South City Drainage Maintenance Division is unaware of reports of sustained levels of flooding on Grand Canal Street Upper. If the specifics of any issues could be provided to DCC Drainage Services, every endeavour will be made to investigate any instances of flooding and coordinate a response from the relevant DCC Department(s) responsible.

**Q.53 Councillor Claire Byrne**

To ask the Area Manager can he please carry out an inspection of green space on Shelbourne Road (along the wall of the former barracks). There appears to be a rat infestation of rats in the foliage here.

**Reply:**

Housing Maintenance Southside Mobile Crew treated this area for pest control on the 4th October 2022 and will continue to monitor the area.

**Q.54 Councillor Claire Byrne**

To ask the Area Manager can he please carry out a survey of the public drains in the Beggars Bush area, in particular the open drain opposite Slattery's?

**Reply:**

DCC Drainage Division have recently commenced CCTV inspection of the combined sewer network in the vicinity of Slattery's Pub in Beggars Bush and these inspections are ongoing. Furthermore, DCC Drainage Division carried out a series of gully repairs in the vicinity in October 2022. Gullies are cleaned by DCC's Surface Water Maintenance Crews on a periodic basis.

**Q.55 Councillor James Geoghegan**

To ask the area manager if he will set out what changes are DCC undertaking currently in respect of bus stops and other related matters on Highfield Road and Rathgar Road and provided all information and imagery that is available; and if he can set out when DCC expect Bus Connects to publish the final iteration of their proposals in respect of Rathgar and Terenure.

**Reply:**

For the provision of bus stops their location is determined by the NTA and DCC would check the location in terms of safety requirements. Then the bus stop item goes through the TAG process. It is signing & lining work similar other minor works with each location being assessed to ensure that existing services and loading / unloading can continue. The TAG process bring it thought the statutory requirements and it is included in monthly Councillors Area Committee meetings.

Regarding Highfield road, the bus stops at either end of the street, at Fairfield Park / Hillcourt and at Ardagh House / JH Hair Care are important key location for interchanging between routes.

For the two middle stops at Oaklands Crescent, these are now being omitted, thus there will be no bus stops in the middle of Highfield Road.

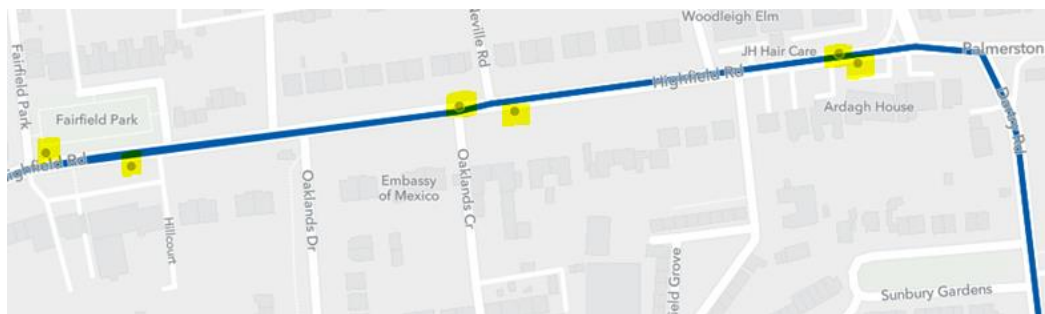

For information regarding the new routes, these details can be found at the BusConnects website but regarding the new route for Highfield road, these stops are for the new south side orbital route S4 connecting Liffey valley to UCD (both directions), part of the BusConnects Redesign network. It is planned to launch this route early next year.

With regards to when Bus Connects to publish the final iteration of their proposals in respect of Rathgar and Terenure, this would with regards to CBC 12 Rathfarnham to City Centre and the NTA plan to submit this scheme to the An Bord Pleanála early 2023.

**Q.56 Councillor James Geoghegan**

To ask the area manager if he will consider proposals and concerns set out below in details supplied in respect of traffic management surrounding St Louis' school in Rathmines.

**Reply:**

The School Mobility Officer has made contact with the parents' association. She will conduct observations of their current assistance of children on their school journey. This meeting will happen in the coming weeks. The school has received a School Zone and this observation will be used to see how it can be improved upon.

**Q.57 Councillor Claire Byrne**

To ask the Area Manager can he please provide a clear timeline for when the drains on Church Avenue and Bath Street will be fixed? They seem to be constantly blocked and, whenever there is the slightest bit of rain, both roads are flooded.



**Reply:**

Further to your query concerning the gullies in the Church Avenue and Bath Street area of Sandymount, Church Avenue and Bath Street are roads that are on a rotational area in Sandymount which is cleaned up to three times per year.

The five gullies on Church Avenue were cleaned in July 2022.

An inspection was carried out on foot of this query and it was found that although there was debris sitting on top of the gullies, they were operational and clean. Ten out of the thirteen gullies were cleaned in September 2022.

Parked cars prevented a clean sweep. These gullies were also checked today and again did not need to be cleaned but had debris removed from the grids of the gullies.

Since 2004 Church Avenue has been checked / cleaned on 105 occasions.

Since 2004 Bath Street has been checked / cleaned on 103 occasions.

There are two reported repairs in this area, one on Church Avenue and one on Bath Street. Repairs at these locations are not straightforward due to traffic management and the presence of high tension ESB cables. Drainage Maintenance Division is examining how best to facilitate a repair.

**Q.58 Councillor Anne Feeney**

To ask the Manager to once again prevail upon Swan Leisure to accept cash for users of the centres in Rathmines and Crumlin. Not everyone wishes to use cards for payment and given that cash is still legal tender it should not be rejected. Allowing patrons to use the facilities free rather than accepting cash as payment is not acceptable as patrons feel they cannot keep coming back expecting to use the facilities free of charge.

**Reply:**

Swan Leisure have put in place a cashless payment system for Crumlin Pool since taking over operation of the facility in the past few months, for a number of legitimate reasons, including security, health & safety etc. The operation of the Crumlin facility is now a matter for Swan Leisure and it is our understanding that alternative systems are in place for those who may not wish to use the contactless system, this of course includes a number of membership options.

**Q.59 Councillor Anne Feeney**

To ask the Manager to reinstate all of the bicycle stands that were removed for construction and /or road works. DCC recently launched Active Travel plans and prolonged removal of bike stands goes against this strategy.

**Reply:**

The cycle stands were removed to facilitate the building project at 199 Harold's Cross Road and they will be reinstated when the project is completed. A suitable alternative temporary location for cycle stands has not yet been identified

**Q.60 Councillor Anne Feeney**

To once again ask the Manager to consider the benefits of having Park Wardens in our larger parks i.e. Eamonn Ceannt; Bushy Park; Brickfield and to have them clearly visible in terms of high-viz jackets.

**Reply:**

Eamonn Ceannt, Bushy and Brickfield Park all have park staff depots located within them. This in effect provides a similar effect to a park warden system in that there are people coming and going during the working day. All of these parks have sports facilities and pavilions which also attract high volumes of footfall which also act as a deterrent to antisocial behaviour.

**Q.61 Councillor Anne Feeney**

To ask the Manager to address the ongoing problem on Lower Rathmines Road of illegal parking, blocking cycle lanes and bus lanes.



**Reply:**

The parking enforcement inspector has compiled a report on the restrictions at Rathmines Road Lower. Some of the restrictions are:

Bus Lane 7 - 10 & 1200pm - 1900pm Mon Sat  
Clearway 7 - 10 & 1200pm - 1900pm Mon Sat  
Loading Bay 7 - 17pm Mon - Sat  
Cycle Track Mandatory 7 - 10 & 12 - 19 Mon Sat

Outside the above hours there is no other restrictions for example bus lane inbound between 10am & 12Midday free parking including a section of the mandatory Cycle Track outbound between 10am & 12Midday.

The Loading Bays are free parking after 5pm daily & all day Saturday / Sunday.

Dublin Street Parking services will patrol the location but enforcement can only take place within the specified times.

**Q.62 Councillor Anne Feeney**

To ask the Manager to progress repair works on Harold's Cross Bridge as a matter of urgency as it is hazardous for bicycles and pedestrians?

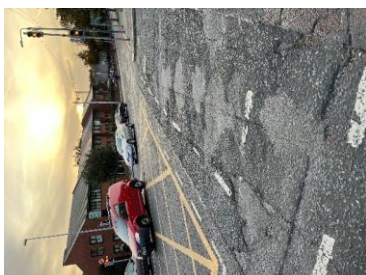

**Reply:**

We carried out an inspection of Harold's Cross Bridge road surface and it is being put forward for consideration for inclusion in our 2023 Carriageway Resurfacing Programme. In the interim, temporary repairs to the potholes will be arranged.

**Q.63 Councillor Pat Dunne**

Can the Area Manager and the Traffic Advisory Group seek solutions to the traffic issue as advised in the attached letter from the Parents Association of St. Louis Infant and Primary school?

**Reply:**

The School Mobility Officer has made contact with the parents' association. She will conduct observations of their current assistance of children on their school journey. This meeting will happen in the coming weeks. The school has received a School Zone and this observation will be used to see how it can be improved upon.

**Q.64 Councillor Pat Dunne**

Can the Area Manager arrange to add a litter bin in Old County Glen which is home to the youth soccer club and has an ongoing litter issue particularly with discarded sport drinks bottles from youngsters coming and going from the club?

**Reply:**

Waste Management Services would not be in favour of installing a litter bin in the above mentioned residential cul de sac as there is a lot of illegal dumping in this area. A litter bin would actually become a focal point for dumping there and make matters worse. We will monitor litter levels here and arrange extra cleaning when necessary.

**Q.65 Councillor Pat Dunne**

Can the Area Manager follow up on my previous requests to have the paths on Kells / Leighlin Green replaced or reinstated. Can this work be completed in 2022?

**Reply:**

Kells Road and Leighlin Green footpaths are not included in our 2022 Footpath Renewal Programme. We will carry out an inspection of these footpaths and put them forward for consideration for our 2023 Footpath Renewal Programme accordingly.

**Q.66 Councillor Pat Dunne**

Traffic goes very fast through the Crumlin village and at cone limits the path is narrow especially coming from the north to south towards Ashleaf. Could we have 30 mph signage and live flashing signage showing the speed cars are going at?

**Reply:**

30 km/h signs should be provided at the entrances to housing estates from main traffic routes where there is change in the speed limit from 50km/h to 30 km/h. Appropriate 30 km/h signage are already in place on both end of the aforementioned area. Signage installed on St. Mary's Road, and there is no change in speed limit when road users turn onto St. Agnes Road from St. Mary's Road, and appropriate signage is also in place on St. Agnes Road at its junction with Cromwellsfort Road / Kimmage Road West / Whitehall Road West.

**Q.67 Councillor Pat Dunne**

Monasterboice Road was scheduled for repaving in 2022. This has not as yet happened. Can I have an update on the new road surface - the situation is pretty bad?

**Reply:**

Monasterboice Road is not included in our 2022 Carriageway Resurfacing Programme. We will carry out an inspection of the carriageway and put it forward for consideration for our 2023 Carriageway Resurfacing Programme accordingly.

**Q.68 Councillor Pat Dunne**

Crumlin Road, shopping area opposite Iveagh Gardens has uneven and dangerous path surfaces. It is impossible for wheelchair or mobility frame users to use safely. From a visual aspect the path / parking looks shabby and chaotic. I am appealing that the area is firstly made safe and flat for everyone and also that planted boxes are added to give the area a sense of pride and beauty. The area has been neglected for years and we shouldn't accept such a shoddy public space.

**Reply:**

We will carry out an inspection of the footpath at this location and arrange for necessary repairs to be carried out.

As has been stated in other replies regarding Planters, the budget for Planters from the Area Office is exhausted. We will look at requests for additional Planters in early 2023.

**Q.69 Councillor Pat Dunne**

Repair a series of bumps and hollows on main where road is sinking in front of Iveagh Gardens houses from the between the bus stops at Scoil Eanna and Iveagh Grounds. These are most acute on the side of the road heading towards city centre.

**Reply:**

We will carry out an inspection of the carriageway at this location and arrange for necessary repairs to be carried out.

**Q.70 Councillor Pat Dunne**

Our engineers came to fix dip in the path where water settles at details supplied about a month ago. When finished the path was worse. Much more water settling. Paving's answer was to grind a channel in the path to allow water to run. Doesn't work. Worse than ever. Can our engineers return and put in place a working solution.

**Reply:**

We will carry out an inspection of the footpath at this location and an alternative solution will be sought to rectify this issue.

**Q.71 Councillor Carolyn Moore**

To ask the Area Manager what measures can be put in place to ensure that the opening hours of Brickfields Park can be extended to accommodate morning and evening park users, joggers, dog walkers and the like. What is the rationale for having an important and well-used local amenity opening at 10am and closing at 5.30pm, with the result that the park is unavailable to anyone who can't use it during working hours?

**Reply:**

The opening and closing times of Brickfields Park are in line with all other Parks within the city and take into account the seasonal availability of daylight hours on a graduated basis.

Closing times are:

January & December	5.00pm
February & November	5.30pm
March & October	7.30pm /6.30pm (adjusted for DST)
April & September	8.30pm
May & August	9.30pm
June & July	10.00pm

**Q.72 Councillor Carolyn Moore**

To ask the Area Manager if the broken manhole / shore cover outside 29 Fortfield Road can be urgently replaced. One corner of the shore is now protruding several inches above ground level and poses a serious risk to road users (see attached image).



**Reply:**

This gully was repaired by DCC Drainage Division on Thursday 27<sup>th</sup> October last.

**Q.73 Councillor Carolyn Moore**

To ask the area manager to write to the Board of Swan Leisure and ensure that a clear, transparent and unequivocal cash policy is in place at the newly reopened Crumlin Swimming Pool. Users report that the pool has not accepted cash payments for swims or sales of goods since the facility reopened, and that no tills are in place to facilitate the handling of cash. Can the manager clarify whether the Management Agreement entered into between DCC and Swan Leisure allowed for such a change in the running of the public facility and undertake to ensure this is reversed if so?

**Reply:**

Swan Leisure have put in place a cashless payment system for Crumlin Pool since taking over operation of the facility in the past few months, for a number of legitimate reasons, including security, health & safety etc. The operation of the Crumlin facility is now a matter for Swan Leisure and it is our understanding that alternative systems are in place for those who may not wish to use the contactless system, this of course includes a number of membership options.

**Q.74 Councillor Carolyn Moore**

Can the area manager undertake to install air and noise pollution monitors on Crumlin Road to measure and seek to remedy the levels of pollution here caused by traffic?

**Reply:**

Dublin City Council is committed to provide enhanced air quality monitoring for the city. This commitment is in the air quality management plan.

It is important to ensure the monitoring locations chosen provide an accurate picture of pollution levels in the city.

The Google Air View project will be completed in 2022. Details of this project (access link below) were presented to the SPC meeting in April 2022.

<https://medium.com/google-earth/using-hyperlocal-air-quality-data-to-improve-dubliners-lives-and-health-45a1db0404>

The results of the project will determine what additional monitoring locations are required.

Additional drives of the street view vehicle will be arranged to traverse Crumlin Road. The NO2 results for those drives will show current pollution levels in the area.

There is noise monitor in place in Dolphins Barn (access link below) that indicates the noise levels in the Crumlin Road area.

<https://dublincityairandnoise.ie/monitor/01550>

**Q.75 Councillor Carolyn Moore**

Can the three way pedestrian crossing / traffic lights at the junction of Kildare Road and Bangor Road be extended to a four way system, as one arm of the junction remains challenging to cross safely for elderly or vulnerable road users?

**Reply:**

This request (Enquiry Ref: 7030110) is referred to the Area Engineer for assessment and report to the Transport Advisory Group for their consideration.

The Councillor be informed of the final recommendations of the Transport Advisory Group.

**Q.76 Councillor Deirdre Conroy**

To ask the Local Area Manager and Planning Department in respect of grant of permission to build apartments including crèches. But developers decide not to build a crèche for residents with young babies and parents have to go to work. While this is mentioned in Harold's Cross, it may be an issue to deal with throughout Dublin.

This was an issue brought up by residents who purchased apartments at Marianella in Rathgar, for the purpose of having a crèche in their residential grounds, and the developer turned down the crèche and requested more 1 bed apartments. Despite a new crèche built years later, there was no crèche for people who purchased in 2018.

**A resident in Harold's Cross has sent on this request:**

In the last 2 years, over 500 apartments have been built within a 1km radius of her home.

There are 3 developments that make up these, two of which were to open crèches on their sites. These crèches have not opened and upon queries with the developers they have no plans of opening. These developments were granted planning permission on the basis of providing this facility however they are under no liability to actually open this once the development has been built.

**Resident has enquired with the Dublin City Council Planning regarding this matter and she states "they have stated that once the planning has been granted, the matter is nothing to do with them."** Why aren't these developments being held liable for not opening these facilities that were to be included?

**Resident states:** she lives in a hugely built up area, all these extra homes being built are putting pressure on already non-existent services. Why are these developments getting planning permission when we don't have services in the area to care for these extra people?

**Resident has had no luck securing any childcare for her son after contacting 10s of crèches.** A first time mother on maternity leave and due to go back to work in April.

**Resident and others state that options are very limited at this stage and it is likely that both parents will have to reduce to part time hours to provide childcare that Harold's Cross area cannot provide.**

**Resident states:** We are both considerable tax payers and it is horrendous that this is now our only option.

**Resident states:** I would be grateful if you could help us with this matter and help raise the issue for these developers leaving crèche units empty once built (Mount Argus Apartments and St Clare's park). Surely at the time of a national childcare shortage, this type of negligence is unacceptable.

**Reply:**

In accordance with the Planning Guidelines for Childcare facilities (2001), one childcare facility (equivalent to a minimum of 20 child places) is required for every 75 dwelling units in all larger residential developments, subject to Section 4.7 of the Design Standards for New Apartments which stipulates that studio and one bedroom units "should not generally be considered to contribute to a requirement for any childcare provision and subject to location, this may also apply in part or whole to units with two or more bedrooms". In keeping with the above guidelines, the Planning Authority always seeks the provision of a crèche in all new residential developments in excess of 75 dwelling units (excluding studio and one bedroom units) except where the applicant can provide an up to date evidence based case that there is already sufficient spare capacity in the area to serve the new development in conjunction with existing demand.

In this respect, I can confirm that the Planning Authority refused planning permission for the omission of the crèche from the Marianella development, notwithstanding the strong case presented by the applicant at the time of the application that the development itself i.e. the residents living in Marianella generated little or no demand for a childcare facility. The omission of the crèche was refused on the grounds that the loss of the crèche "would result in serious injury to the residential amenities of existing and future occupants and would thereby be contrary to the proper planning and sustainable development of the area". It should be noted that the parent planning permission on this site (2186/09) has still not expired and has been extended to 26<sup>th</sup> December 2022 to facilitate completion of the overall development including the provision of the crèche. Furthermore, I can confirm that the Planning Authority dealt speedily with the application for omission of the crèche which was submitted in October 2019 with a decision to refuse issued in November 2019.

In relation to the Mount Argus development on Mount Argus Road/Lower Kimmage Road, it would appear that the relevant planning permissions requires the provision of a crèche of circa 138 sq metres in Block j. Likewise, two of the later permissions for the St. Clare's development have similar requirements for the provision of a crèche of circa 150 sq metres with associated outdoor play space. In light of the failure to provide a crèche /childcare facility on these sites to date, it is proposed to contact the relevant parties to pursue this matter. It should be noted based on feedback from developers, that the failure to open a childcare facility may lie in difficulties in securing an operator.

**Q.77 Councillor Deirdre Conroy**

To ask the Local Area Manager and Roads Department for safety pedestrian crossing and school warden for new Educate Together National School in Harold's Cross, where there is extensive traffic in and out of the city. This is a system needed for child walkers and cyclists which is a major requirement of Dublin City Council to reduce cars. While it is a Harold's Cross enquiry, it may also be an issue throughout new schools in Dublin.

Enquirer states that there is a severe lack of pedestrian safety measures surrounding the school. It was not possible to provide photography through DCC iPad.

**Enquirer Detail:**

"In an effort to be more eco-friendly, our family has chosen not to own a car, so we walk to school every day from Rathmines. The walk is safe until we reach Harold's Cross Road and Leinster Road.

This crossing is very dangerous for the multitudes of children walking, scootering, and biking to school. There is a traffic light but no pedestrian crossing signal so it's difficult to tell when we are safe to cross the road. To make matters worse the cars go very fast through that intersection and never stop for pedestrians.

The entrance to the school is even worse. The front gates open up to direct oncoming traffic and we have no school wardens to ensure child safety. There is one pedestrian traffic light across the street from the school and that is all. We also cannot walk directly from the school to the park safely.

Cars turn quickly in and out of the front gates of the school from the main road with no idea that they are turning into a primary school with small children. There are no signs to indicate that it is a school zone. There are also no bollards to stop cars from parking on sidewalks directly in front of the school and blocking the entrance for pedestrians.

Lastly, the school has a long winding entrance beyond the gate that leads to the actual school grounds and there is no sidewalk until you turn the blind corner. It's a very unsafe area especially for small children.

I have tried to enclose pictures so that you can see why I am concerned but your email says my attachments are too large. I would really appreciate if you could help me figure out how to gain funding for school wardens to help make the school a safer place for children."

**Reply:**

A school warden is provided for children from 2<sup>nd</sup> class up to 6<sup>th</sup>, generally children over the age of 8, who are unaccompanied crossing the road. It should be noted that School Wardens are provided at crossing points to cross children safety going to and from school were warranted, and not to control parking outside of schools.

***A request for a school warden to assist children will be assessed and referred to the Traffic Advisory Group for examination. The Councillor will be informed of the recommendation in due course.***

Dublin City Council supports sustainable modes of transport such as walking and cycling. There are signalised pedestrian crossings 60 metres to the south of Leinster Road on Harold's Cross Road and at a location 160 metres to the north which is 110 metres away from the new Educate Together National School in Harold's Cross.

The Transport Advisory Group has recommended that the junction of Leinster Road / Harold's Cross Road be upgraded to have signalised pedestrian crossings. This is all dependent on funding being made available.

At present this junction is on the Bus Connects Transportation route and the junction will be considered to be upgraded as part of this scheme

The Transport Advisory Group Area Engineer will assess the entrance of the school.

**Q.78 Councillor Danny Byrne**

To ask the Manager to have the footpaths at Havelock Square resurfaced. In reply can I please be informed of when these footpaths were last resurfaced?

**Reply:**

We will carry out an inspection of the footpaths on Havelock Square and put them forward for consideration for inclusion in our future Footpath Renewal Programmes accordingly. We will check our records for information on when the existing footpaths in Havelock Square were constructed and revert with our findings.



**Q.79 Councillor Tara Deacy**

Could DCC please look at a solution for the benches in Ravensdale Park? They attract anti-social behaviour and are constantly surrounded by rubbish. There is a bin on either side of the park, but these are not used, so the benches are left surrounded by vodka bottles, beer cans etc. Since they were installed, residents have had to avoid the park on several occasions as just groups of young men gathered, smoking and drinking.

**Reply:**

Ravensdale Park is litter picked on a weekly basis in line with other parks and open spaces in the area. Benches are provided to allow people to rest and enjoy the park and extend their stay. One bench is located beside the tree of Hope to facilitate any one visiting this feature. This is the first report of anti-social behaviour that Parks have received in relation to this park. Issues with serious anti-social behaviour should be reported to An Garda Síochána. There is a low wall surrounding the park which can also serve as seating so removing benches would not necessarily address the issue.

**Q.80 Councillor James Geoghegan**

To ask the Area Manager if he will consider the issues raised in the emails below and attached images (details supplied).

**Reply:**

This request (Enquiry Ref: 7025406) is referred to the Area Engineer for assessment and report to the Transport Advisory Group for their consideration.

The Councillor be informed of the final recommendations of the Transport Advisory Group.